

Scale 1:200

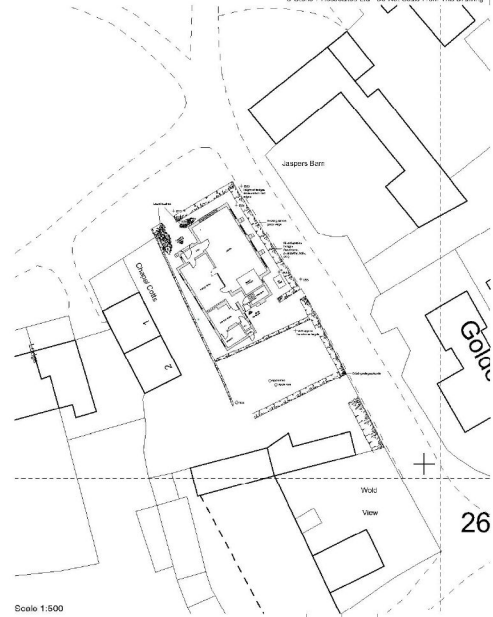

© Stone + Associates Ltd - Do Not Scale From This Drawing



Scale 1:500

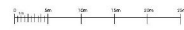

A	00000	00000	00
Rev	Date	Drawn/Checked	Description
01			

Mr. Andrew Chapman & Mrs. G. Gill - Chapel & Barn
 Mr. Richard P. Stone - Chapel & Barn

STONE + ASSOCIATES
 ARCHITECTS AND SCAPERS
 The Square, 70 Saville Street, Milton, North Yorkshire, YO17 7LL
 01653 618103
 enquiries@stoneassociates.co.uk
 www.stoneassociates.co.uk

Site: Barton-le-Wilms Methodist Chapel
 Address: Barton-le-Wilms YO23 7PD
 Client: Methodist Chapels

Drawing: Existing site plan

Scale	1:500, 1:200	Date	14.08.15	Drawn	BE/MP	MM	
Sheet	4353	Project Code	EX10	Phase	A	Sheet No.	A3

PLANNING ISSUE

DATE VALID
02/12/15

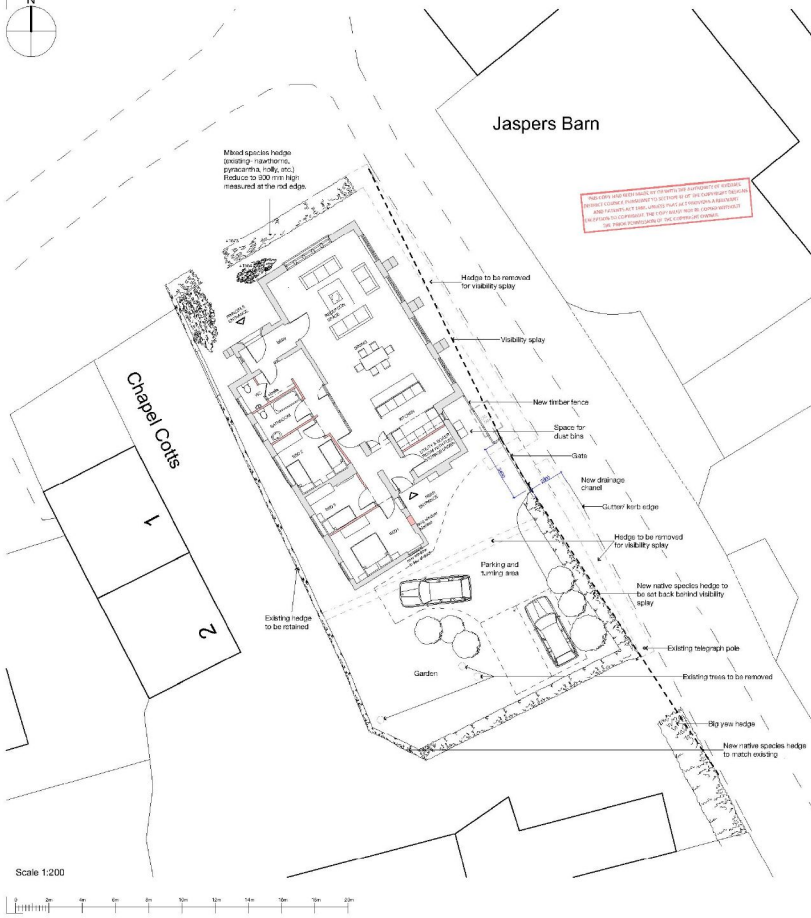

Scale 1:200



© Stone + Associates Ltd - Do Not Scale From This Drawing

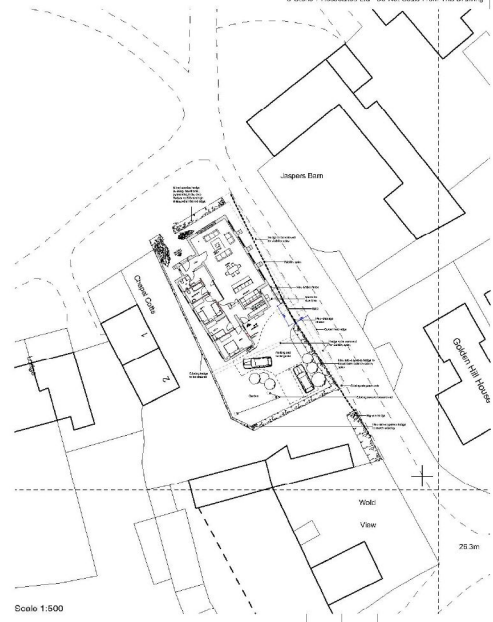

Scale 1:500

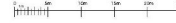

A 0000 0000 0000 0000
 No. Date Project Name
 Mr Andrew Hughes Mr G. Johnstone Mr J. M. Conner
 Mr. Richard P. Cooper Mr. Peter S. H. Kelly

STONE + ASSOCIATES
 ARCHITECTS AND SCULPTORS
 The Square, 70 Saville Street, Milton, North Yorkshire, YO17 7LL
 01654 618103
 www.stoneassociates.co.uk
 www.stone-associates.com

Site Barton-le-Wilms Methodist Chapel
 Address Barton-le-Wilms YO3 7PD
 Client Methodist Chapels

Drawing Proposed site plan
 Contained/Deleted in: A3/A4/Exhibit

Rev	Description	Date	By	Check
As shown	02.11.15		MM	MM
4353	ARTD	01	C	A3

PLANNING ISSUE
 DATE VALID 02/12/15